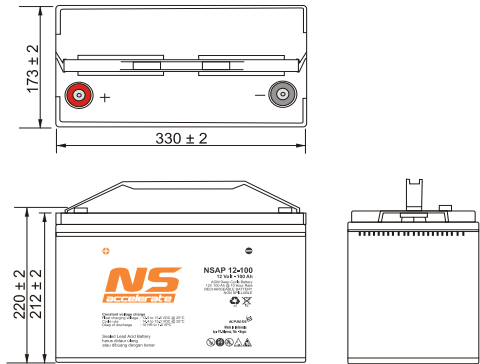
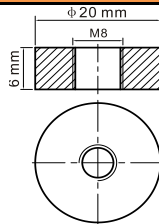

TECHNICAL SHEET
NSAP 12-100

NSAP 12-100 is a top terminal battery with AGM technology is specially designed for Telecommunication use with over 10 years design life at 25 °C. NSAP type also comply with IEC 60896-21/22, standard battery for Stationary Lead Acid batteries. The adoption of centralized venting system make sure the battery can be installed in any location and guarantees high security and reliability.

VIEW

DIMENSIONS

TERMINAL SIZE

WEIGHT AND DIMENSION

Battery Weight	: Approximate	30.4 Kg
Length	: 330 ± 2	mm
Width	: 173 ± 2	mm
Height	: 212 ± 2	mm
Total Height	: 220 ± 2	mm

PERFORMANCE

Nominal Voltage	: 12 V
Capacity 10 h (C ₁₀)	: 100 Ah
Max Discharge Current	: 1200 A (5 sec)
Internal Resistance	: Approx. 4.9 m Ω
Normal Operating Temp. Range	: 25°C ± 5°C
Float charging Voltage	: 13.5 to 13.8 VDC/unit@25°C
Recommended maximum charging current limit	: 30 A
Equalization and Cycle Service	: 14.4 to 15.0 VDC/unit@25°C
Self Discharge	: Self-discharge ratio less than 3% per month at 25°C. Please charge batteries before using.

COVER AND CONTAINER

Material	: A.B.S. UL94-HB, UL94-V0 Optional.
Type	: NSAP 12-100
Terminal	: T11

OTHER

Operating Temperature Range	-15°C to 50°C	Discharge
	0°C to 40°C	Charge
	-15°C to 40°C	Storage

Discharge Characteristic Curve

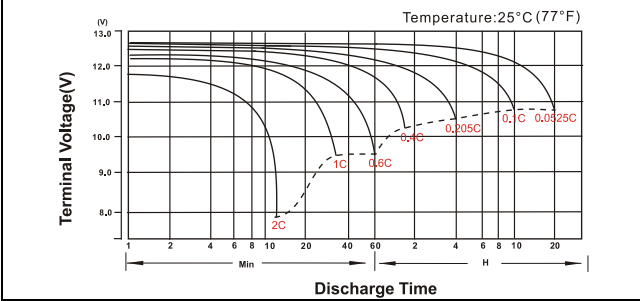

Float Charging Characteristics

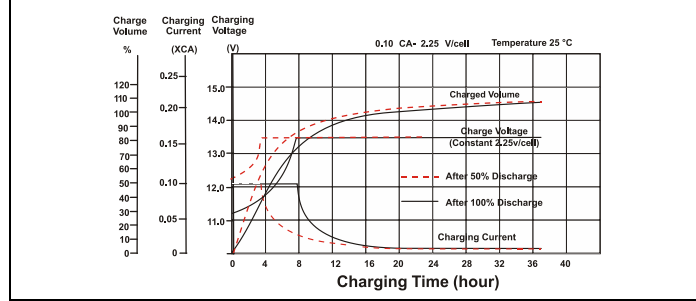

Temperature Effects in Relation of Battery Capacity

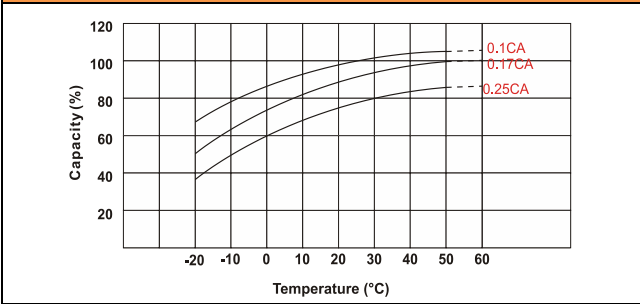

Effect of Temperature on Long Term Float Life

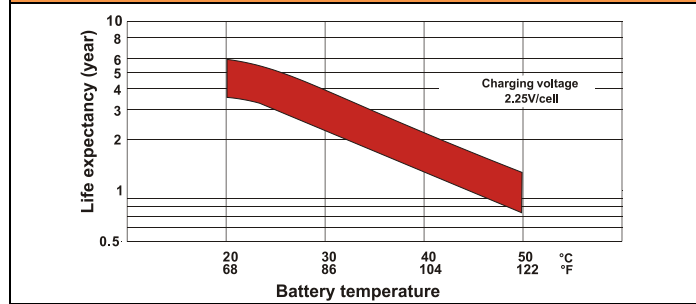

Graphic Life Cycle

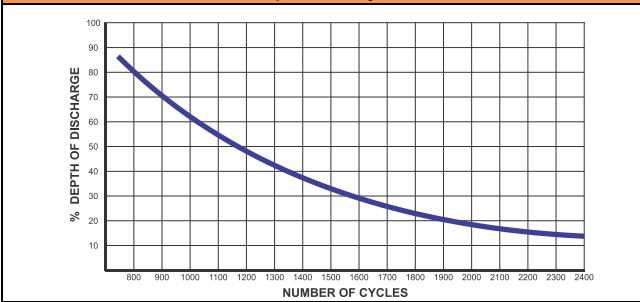

Self Discharge Characteristics

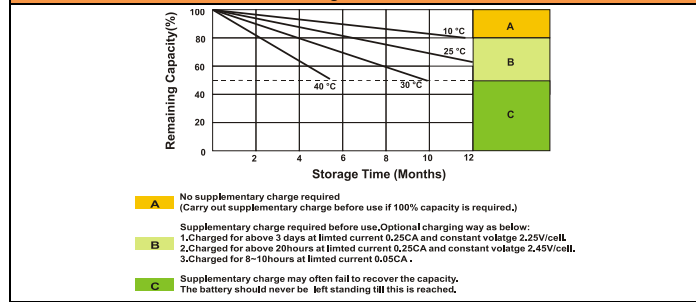

Constan Current Discharge (Amperes) at 25 °C

F.V/Time	5 min	10 min	15min	20min	30 min	45 min	1 h	2 h	3 h	4 h	5 h	6 h	8 h	10 h	20 h
1.85 V/cell	173.60	146.40	130.20	115.30	87.50	65.20	52.40	31.30	23.50	19.20	16.40	14.40	11.60	9.65	5.13
1.80 V/cell	210.00	167.60	143.70	123.50	92.10	68.70	55.10	33.10	24.60	20.20	17.20	15.00	12.00	10.00	5.20
1.75 V/cell	237.00	186.30	154.00	130.80	96.50	71.30	57.10	34.40	25.40	20.70	17.60	15.30	12.20	10.10	5.29
1.70 V/cell	261.60	199.50	165.10	138.90	101.80	74.60	59.50	35.30	26.00	21.20	17.90	15.60	12.40	10.20	5.34
1.67 V/cell	291.70	215.10	178.50	146.60	106.70	77.40	61.90	36.30	26.70	21.70	18.30	15.90	12.60	10.30	5.40
1.60 V/cell	330.80	232.50	188.50	154.30	112.30	80.50	63.80	37.50	27.60	22.20	18.60	16.20	12.70	10.50	5.45

Constant Power Discharge (Watt/cell) at 25 °C

F.V/Time	5 min	10 min	15min	20min	30 min	45 min	1 h	2 h	3 h	4 h	5 h	6 h	8 h	10 h	20 h
1.85 V/cell	322.50	274.90	247.10	220.50	168.50	126.40	102.20	60.80	45.70	37.50	32.20	28.20	22.90	19.10	10.20
1.80 V/cell	386.40	312.20	271.00	235.10	176.80	132.70	107.20	63.80	47.70	39.20	33.60	29.40	23.70	19.80	10.30
1.75 V/cell	431.30	344.90	288.70	247.80	184.30	137.30	110.80	66.00	49.10	40.10	34.30	29.90	24.00	19.90	10.40
1.70 V/cell	470.90	366.50	307.70	261.80	193.60	143.00	115.00	67.60	50.10	41.00	34.80	30.40	24.30	20.10	10.50
1.67 V/cell	519.30	391.40	330.20	274.50	201.90	147.70	119.10	69.20	51.30	41.80	35.30	30.80	24.60	20.30	10.60
1.60 V/cell	578.90	418.20	345.10	286.60	211.10	152.90	122.40	71.10	52.70	42.60	35.90	31.30	24.80	20.50	10.70

All mentioned values are average values (Tolerance ± 2 %)